



**Tailte
Éireann**

Clárúchán, Luacháil,
Suirbhéireacht
Registration, Valuation,
Surveying

Tailte Éireann Sealed and Certified Copy Folio (& Title Plan)

JOHN V KELLY & CO LLP SOLICITORS
DX 21002
CAVAN

This page forms part of the official document. Do not detach.

Folio Number: CN13454
Application Number: P2024LR071536Q
Your Reference: 2/c347b/1/dc

This document comprises a sealed and certified copy of the Tailte Éireann record for the above mentioned folio/title plan as of the date appearing.

Details of **dealings pending** (if any) are listed in the **Schedule** below.

An officer duly authorised by Tailte Éireann

Schedule



Notes:

1. Title plans should be read in conjunction with the folio. The description of the land on the folio or on the title plan is not conclusive as to the boundaries or extent of the land (see Section 85 of the Registration of Title Act 1964, as substituted by Section 62 of the Registration of Deeds and Title Act, 2006).
2. Title plans greater than A3 in size may be provided as separate A3 tiles with an overlap and print gutter. When aligning the tiled sheets, customers are advised to use the underlying topographical detail.
3. On receipt of this record, please check to verify that all the details contained therein are correct. If this is not the case, please return the document to Tailte Éireann immediately.

Land Registry

County Cavan

Folio 13454

Register of Ownership of Freehold Land

Part 1(A) - The Property

Note: Unless a note to the contrary appears, neither the description of land in the register nor its identification by reference to the Registry Map is conclusive as to boundaries or extent

No.	For parts transferred see Part 1(B) Description	Official Notes
1	<p>The property shown coloured RED as Plan(s) 13454 on the Registry Map, containing 2.1752 Hectares, situate in the Townland of DRUMAVADDY (CLANMAHON BY), in the Barony of CLANMAHON, in the Electoral Division of DENN.</p> <p>The registration does not extend to the mines and minerals.</p>	<p>From L.R.16/21011</p>

Land Registry

County Cavan

Folio 13454

Part 1(B) - Property
Parts Transferred

No.	Prop No:	Instrument:	Date:	Area (Hectares):	Plan:	Folio No:

643960 mE, 797950 mN



Tailte Éireann
Clárúchán, Luacháil,
Suirbhéireacht
Registration, Valuation,
Surveying

Folio: CN13454

This map should be read in conjunction with the folio.

Tailte Éireann (TÉ) Registration mapping is based on TÉ Surveying mapping. Where TÉ Registration maps are printed at a scale that is larger than the TÉ Surveying scale, accuracy is limited to that of the TÉ Surveying map scale.

For details of the terms of use and limitations of scale, accuracy and other conditions relating to TÉ Registration maps, see www.tailte.ie.

This map incorporates TÉ Surveying map data under licence from TÉ. Copyright © Tailte Éireann and Government of Ireland.

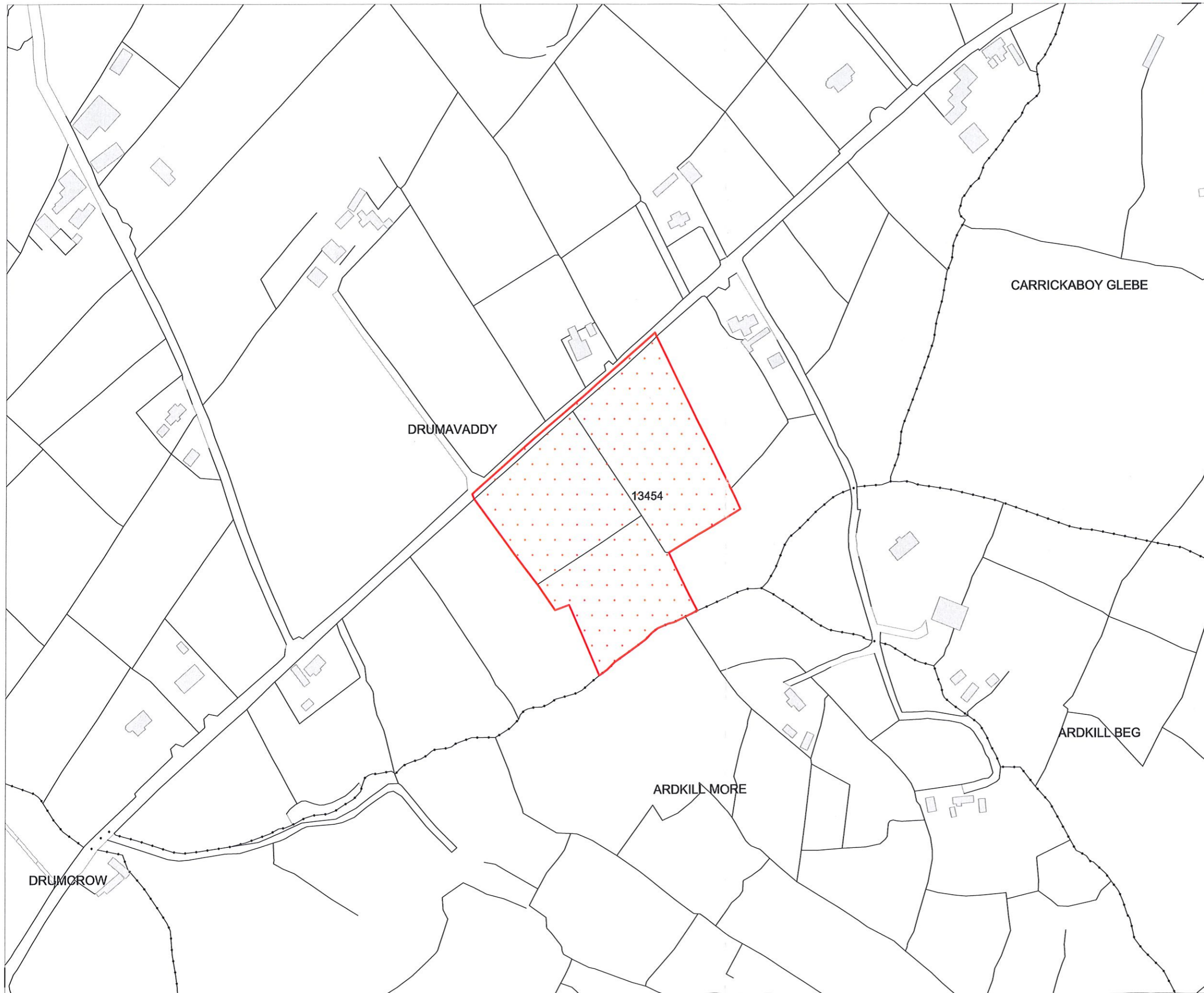

- (centre-line of parcel(s) edged)
- Freehold
- Leasehold
- SubLeasehold

Burdens (may not all be represented on map)

- Right of Way / Wayleave
- Turbary
- Pipeline
- Well
- Pump
- Septic Tank
- ▽ Soak Pit

A full list of burdens and their symbology can be found at: www.landdirect.ie



Tailte Éireann Registration operates a non-conclusive boundary system. The TÉ Registration map identifies properties not boundaries meaning neither the description of land in a folio nor its identification by reference to a TÉ Registration map is conclusive as to the boundaries or extent. (see Section 85 of the Registration of Title Act, 1964). As inserted by Section 62 of the Registration of Deed and Title Act 2006.

